

### Transportation and handling of containers

Please read the instructions carefully before starting the installation.

Handle the containers with care. Lift the containers only from the lifting loops, attaching lifting aids of at least 1,500 mm to them. NOTE! The lifting loops must be removed from the containers after installation

### Contents of the delivery

Lids, quick lifting equipment and lifting bags are delivered on a separate pallet. Lifting containers are delivered inside the containers. Small parts, along with the picture of the ordered container group, can be found in the accessory box. **If the lids are delivered on a separate pallet, open the packaging band (or plastic wrapping) around the lid pallets immediately after transportation. The lids must not be stored with the packaging band tightened.**

### Installation location

Choose an installation location where the surface water drains away from the container, and make sure that rainwater is not directed to the planned installation site.

Check the excavation potential, cables, pipelines and other things to consider in advance at the installation site.

Position the container so that there is enough space around and above the container for emptying.

Also take into account eaves, branches, air cables, etc., according to Molok Ltd's recommendations. The minimum distance between the containers and fixed structures, for example, fences that are higher than the container, is 500 mm. Take into account the space required by the emptying truck, as well as access to the containers for maintenance purposes, even in winter conditions. If the containers are equipped with a hinged lid (1/3), take into account the space required for opening the hinge (approx. 50 cm).

Observe fire safety and consult the fire department to determine a safe installation location.

### Installation

Molok®Domino Global containers are installed at a depth of 1.6 mm. In group installations, the containers are fastened to each other from the top.

The containers are delivered with framing, but the extension pieces of framing and the extension cover pieces are to be fastened in place only after the groundworks are completed at the installation stage. The sides between containers are not framed. Small parts and needed fastening accessories are in a separate accessory box.

The lifting loops attached to the container are intended for lifting and moving the container at the installation site.

They must be removed after installation prior to using the containers.

Follow good installation practices and occupational safety regulations during installation.

If MolokDomino Global container wells are installed in the same group with concrete frame MolokDomino wells, follow the further instructions on page 5.

### Installation pit

Depth of the pit: 1,600 mm from final ground level. Width of the pit: 2,400 mm.

The length of the installation pit is determined as follows: 1,690 mm x number of containers + 800 mm.

Carefully level the bottom of the pit with 0/16mm crushed gravel. Check that the base is straight by using a spirit level or line laser and compact the ground carefully. Maximum groundwater height from the bottom of the container 0.5 m. If the bottom anchors are delivered loose, attach them to the container inserts with bolts, tightening the bolts to max. 25 Nm.

Lift the container into the pit using the lifting loops. NOTE! Remove the lifting loops after installation.

Leave 45 mm between adjacent containers to ensure that the lids fit. Make sure that the distance between the containers is the same, also at the back, if the containers are installed back to back.

Align the front sides of the containers and check that the container group is straight, using a mason line.

Use a spirit level to check that the containers are vertical.

The height/straightness of the containers can be adjusted by loosening the anchorage feet bolts and adjusting the height, tighten the bolts to max. 25 Nm.

Attach the containers to each other with the u-shaped parting strip.

See Image 1. The parting strip must be drilled through the edge support frame and fastened at eight points with pop rivets included in the delivery.

The same installation method applies to installing Molok®Domino Global containers in the same group with other Molok®Domino products.

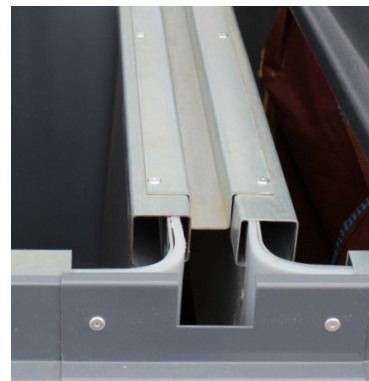

Image 1. Fastening the U-strip

### Filling the installation pit

Fill the pit as shown in the image 2, using different soil types.

Fill the pit evenly, adding soil to both sides of the container to prevent moving. Fill the pit in layers of 200–300 mm, compacting the soil with moderation. Fill the gaps between the container bodies up to the final ground level. Fill the gap as high as possible and finish with Leca gravel that is included in the delivery.

The installation site can be finished with fine crushed stone, paving, etc. Make sure that surface water flows away from the containers.

Finishing layer  
100 mm

Ballast  
Crushed gravel 0/16 mm or excavation soil if the soil type is not freezing (e.g. clay, silt). Stones with diameter more than 100 mm have to be removed. Filter cloth may be used between the ballast and the gravel.

Anchoring layer  
Gravel 16/32 min. 500 mm layer

Bottom layer  
Crushed gravel 0/16 min. 50 mm layer

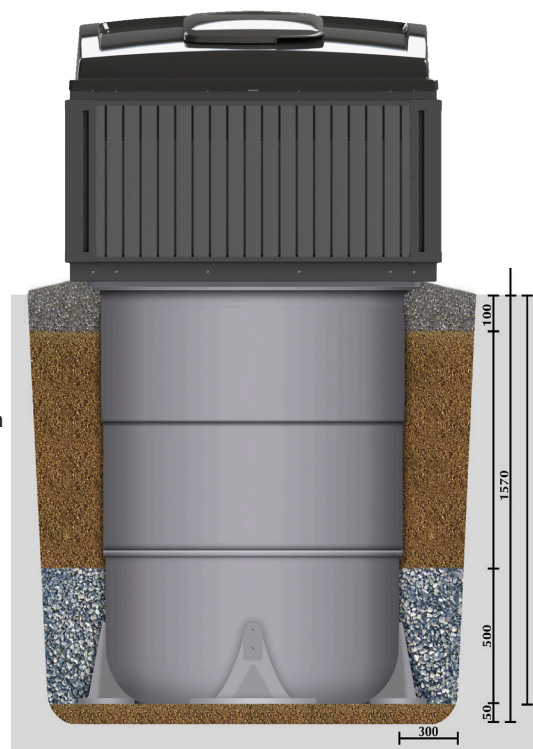

Image 2. Installation pit

### Finishing the framing

- First, fasten the lower extension cover piece (A) in line with the lower edge of the framing element. Insert the vertical extension piece (B) and attach the upper extension cover piece (C).
- Finally, attach the vertical extension piece (B) with blind rivets to the extension cover pieces (A+C). Make sure the vertical extension piece (B) is straight.

### Installation of lids and bags in container bodies

- Lids and bags are delivered separately as sets, on their own pallet. Check that the bottom of the lifting bag is closed tightly and the rope is in place according to the instructions on the bag. The closing mechanism of an empty bag may open during transportation.
- Put the lids with their quick systems and bags into place and make sure that the bag is aligned with the edge of the container. Especially for smaller bags, make sure that the bag is not left crumpled after transport and installation.
- Install the right lid and bag in the right position in the container group. The correct installation location within the group is marked both on the container bodies and the lid sets. **In divided containers, installing the lid in the right place is important for the functioning of the product.** You can also check the correct location in the image, delivered in the accessory box.
- If the lid is not attached to a quick system, secure the lid with M8 x 35 torx screws. Install a cover plate on the lifting loop opening, fasten the plate with a screw; see Image 6.

### BioSystem lifting container instead of a lifting bag

- The MolokDomino Global container can be used with surface-type lifting containers, KS 1/6 Top (220 l) or KS 1/3 Top (500 l), which are always placed at the end of the container group on their own shelf. With 1/6 Top lifting containers, a separate side hinge is used instead of the quick system. Hinge installation instructions below.

### Side hinge attachment

- The side-hinged lid is always located at the end of the container row, on the KS 1/6 Top lifting container. Note that opening the lid and using the product as intended requires approximately 50 cm of free space beyond the edge of the container.
- Connect the hinge parts of the lid and the container body with 8 mm bolts. The side hinge stop chain is secured to the support beam in the container. Attach the other end of the chain to the lid with a 6 x 30 mm locking bolt as shown in Image 7.
- If the container group has a KS 1/6 Top inner container for bio-waste collection, install the first Bioska® disposable bag in the container and attach the bag with a rubber band that can be found in the accessory box, as shown in Image 7 on the next page.

### Finishing

Make sure that the containers remain neat after installation; the framing extension pieces are in place, and the lids fit well in their correct places, with the hinges correctly installed. Marks left during installation or transport must be wiped off the lids as well as the framing, and the numbering tapes used for marking the location must also be removed from the lids.

Make sure that no water remains in the containers after installation and transport. Any water must be removed from the container before handing the installation over to the customer

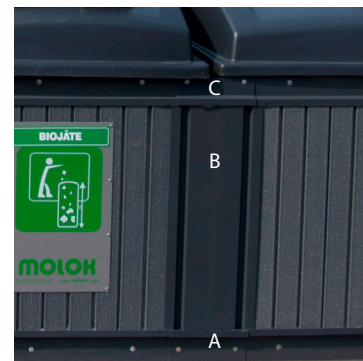
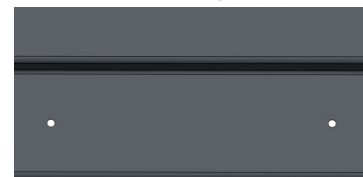

Image 3. Finishing the framing

Lower extension cover piece A



Upper extension cover piece C



Image 4. Framing extension pieces A and C



Image 5. Lids and lifting accessories for a container body that is divided into three parts. In divided containers, it is important to install the lids correctly. Please note that the components intended for different locations are different.



Image 6. Quick system loop and cover plate

### Note!

If the containers are stored without lids before installation, you must cover the containers with plastic or plywood boards or similar to prevent rainwater from accumulating inside the container.

If water gets in the container, remove it by pumping.

Do not make holes in the container to drain the water. If the lid, quick lifting equipment and bag are bundled together with a tight band/plastic for transport, remove the band before storage.



Image 7. Installation of the side hinge chain and disposable bag

### Parts and accessories included in the delivery

#### Note! Small parts are in a separate accessory box!

- Container body with framing, with waste type sign attached
- Finishing parts for the framing
- Lids, bags and quick systems
- Leca® gravel for filling the gap between the containers
- Locking pieces, if needed

### Parts and tools needed in the installation

- Drilling machine with torx heads and a 5 mm bit
- Open-end spanner 17
- Riveting pliers and heads
- Spirit level
- Digging bar
- Shovel
- Street brush
- Ladder 3 m
- Hammer

### Impact of soil type on the installation method

#### 1. Anchoring the container to dry or slightly moist soil

Make sure that the soil type is water permeable, such as sand, silt, gravel, moraine, etc. Perform the installation as instructed above. If the soil type seems to have poor drainage, or surface water may accumulate at the installation site, consider installing the containers according to point 3 below.

#### 2. Anchoring the container to wet soil or soil with clay

Use a filter cloth, of at least class N1, in the installation pit. Spread out the filter cloth on the bottom of the pit under the levelling layer. Check that no rocks are laid against the cloth as they may break the material. Make sure to spread the filter cloth to properly cover the sides of the pit. Attach the bottom anchors to the container in accordance with the instructions on page 2. Install a plywood plate (# 15 mm, 820 x 300 mm) as an extra anchor between each bottom anchor. Install the plywood on top of the bottom anchors so that the centre inner edge of the plate is supported by the lower part of the container frame and the outer edge is in line with the bottom anchors.

Fasten the plywood plate by screwing it at both ends to the bottom anchors (e.g. with 4 x 40 mm screws).

If necessary, install subsurface drainage on the bottom of the installation pit under the levelling layer.

Finish the installation as instructed above.

#### 3. Installing at a very wet site

Start the installation according to the instructions above. Use crushed gravel, for example 0/16 mm, for building a levelling layer under the containers.

Lift the containers onto the installation pit and cast a 30–40 cm layer of ready-mixed concrete (for example K30, #16 mm, S3) on top of the levelling layer and around the container.

Make sure that the containers do not move when the concrete is cast. Finish the filling of the surroundings as instructed. If necessary, install subsurface drainage on the bottom of the installation pit under the levelling layer. Finish the installation as instructed above on this page. If water accumulates in the installation pit during installation, and it is not possible to direct the water elsewhere from the installation pit, such as with the help of subsurface drains, the container must be installed in a drier installation site.

### Installation in the same group with concrete made MolokDomino containers

- Start the installation with the concrete MolokDomino container bodies
- Follow the separate MolokDomino installation instructions for handling concrete bodies and take into account the weight of the product as well as occupational safety.
- If there are several container bodies in the group, they must always be installed next to each other and attached to each other with the metal slabs included in the delivery, in accordance with the instructions.
- After installing the container body, lift the plastic container into the pit using the lifting loops. Leave 45 mm between the top of the concrete body and the metal slab of the plastic body.  
The gap is needed to ensure that the lids fit properly.
- Align the plastic body with the concrete body. Check the straightness of the container group. The height of the plastic bodies can be adjusted from the anchor feet as instructed above.
- Attach the concrete bodies to the plastic bodies using a parting strip, as shown in Image 9. The parting strip must be drilled through the edge support frame and fastened to the wells at eight points with pop rivets that are included in the delivery.
- After attaching the parting strip, finish the installation by following the MolokDomino Global installation instructions above.



Image 8. Lifting the wells to the installation pit



Image 9. Fastening the plastic well to the concrete well.

Instructions are made in Finland. Always follow local laws and regulations and follow good installation practices. Pay attention to different soil types at different locations. Contact your local dealer for further information. Contact info available at [www.molok.com](http://www.molok.com).